

PLAN SHOWING THE PROPOSED SUBDIVISION PLAN IN S.NO. 36/5 PART OF VENGAIVASAL VILLAGE, SHOLINGANALLUR TALUK, ST. THOMAS MOUNT UNION LIMIT, KANCHEEPURAM DISTRICT.

மசலயஸ்டிரீட் / மசல சீ-டிரிபிள் அனுமதி எண்... **68/2014** KANTLAND
 மசல சீ-டிரிபிள் அனுமதி எண்... **3.2.14** ஒப்புதலளிக்கப்பட்டிருந்து
 மசல சீ-டிரிபிள் அனுமதி எண்... **4.31/30.14** 40'-0" [12.20m]

வ. சி. டி. 20 [20m]
 தலைவர்
 மசல சீ-டிரிபிள் அனுமதி எண்... 600 072

Planning Permit No **43/2014**
APPROVED
 25/5/2014 27/6/14

Sum of the conditions in this Office Letter
 25/5/2014 27/6/14
 Members Secretary
 CMDA Chennai

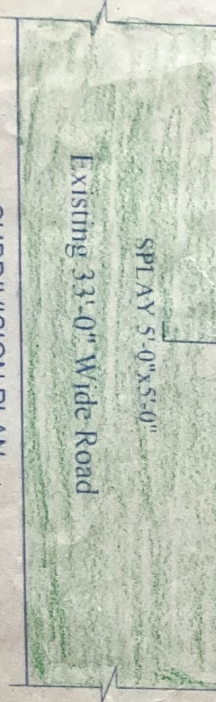
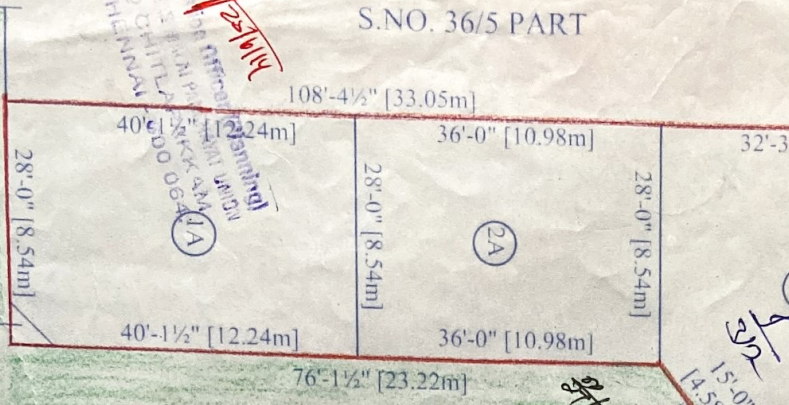

SUBDIVISION PLAN



North:-

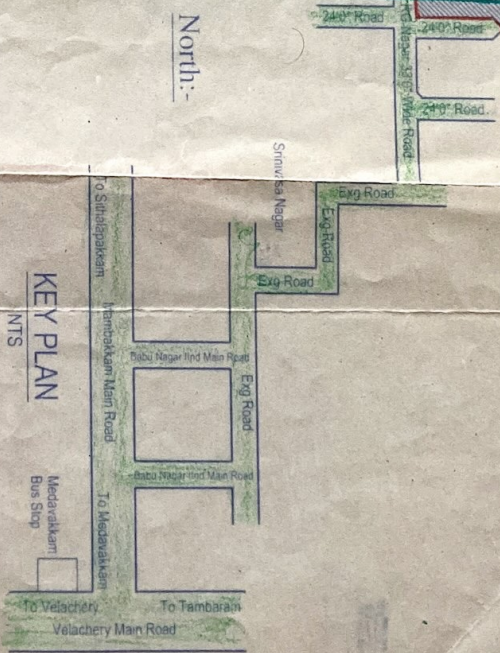

COLOUR INDEX:	OWNER/POWER AGENT SIGNATURE	AREA STATEMENT
[Red Line]	 P. Ramkumar Owner/Power Agent Signature	SITE EXTENT - 3329 SQFT [309.39 SQ.M]
[Green Line]		PLOT NO. 1A - 1123 SQFT [104.37 SQ.M]
[Blue Line]		PLOT NO. 2A - 1008 SQFT [93.68 SQ.M]
[White Box]		TOTAL - 3329 SQFT [309.39 SQ.M]
LICENSED SURVEYOR P. Ramkumar P. Ramkumar, B.E., Licensed Surveyor / I.S. No. 1476, Class-II Corporation of Chennai OFF: VIEW POINTS No: 102 (1A), Pallavaram, Chennai-600 043. Mobile: 9884211214 E-Mail: vpoints@rediffmail.com		
VIEW POINTS Consulting Engineers & Licensed Surveyors 102 (1A), GST Road, Pallavaram, Chennai-43 Ph: 044-3257 4555, Telefax: 044-2764 4252		